



**CONTAINER**

**KATALOG**

Container Catalogue

# VILLA

PREFABRİK



## **ABOUT US**

*In 1999 three young businessmen established Villa Yapı with a grand vision and a goal to build quality prefabricated houses, office buildings, social and community facilities, earthquake houses and light steel structures. The continuous growth enabled Villa Yapı to expand their core business into steel construction and Container production to be one of the leaders in the industry.*

## **Our company;**

*Various sizes of prefabricated homes, work site buildings, social and community facilities, hospitals, Schools, Office and living containers, steel structures are built for domestic and International customers, successfully, for the past 15 years.*

*Customer satisfaction being the main goal, technical and administrative staff can offer fast and quality solutions to customers' projects.*

*With Tuzla-Istanbul 1500 m<sup>2</sup> showroom Gebze- Kocaeli 20000 m<sup>2</sup> manufacturing facility with over 300 qualified associates Villa Yapı is proud to contribute to Turkish economy.*

<i>Prefabricated Buildings Modular Containers</i>	<i>15000 m<sup>2</sup></i>
<i>• Disassembled Containers</i>	<i>500 adet</i>
<i>Light Steel Buildings</i>	<i>300 adet</i>
<i>• Heavy Steel Buildings</i>	<i>7000 m<sup>2</sup></i>
	<i>5000 m<sup>2</sup></i>

*Is capable of producing.*

























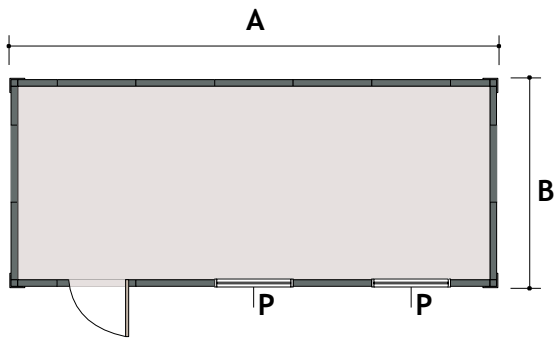

# CONTAINER PLÄNE

# CONTAINER PLANS

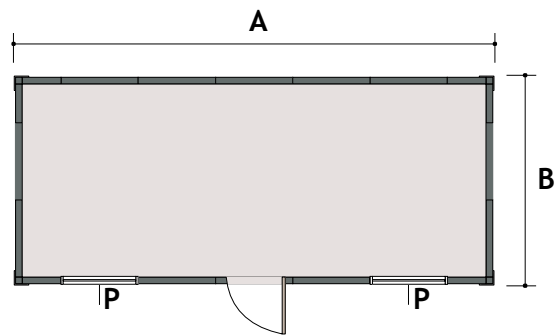

**VK 101** 



**VK 102** 

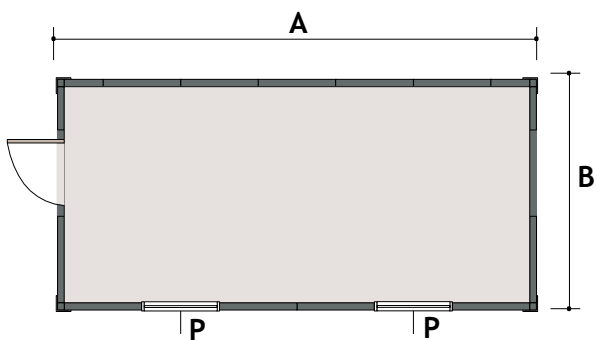

**VK 103** 

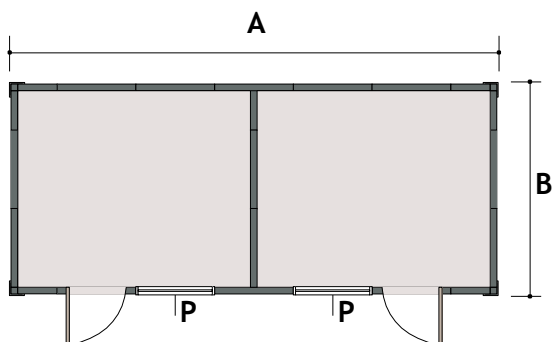

**VK 201** 

**A** 7m 6m  
**B** 3m 2,4m



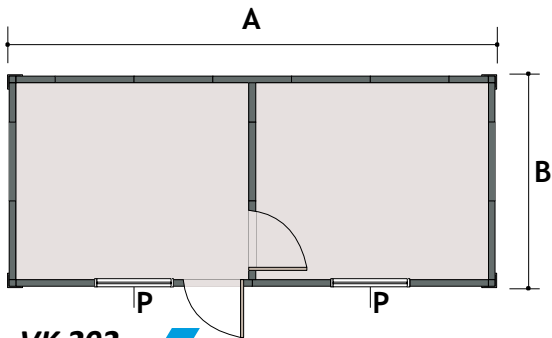

VK 202

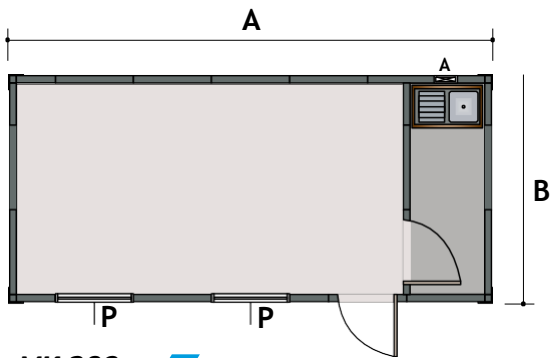

VK 203

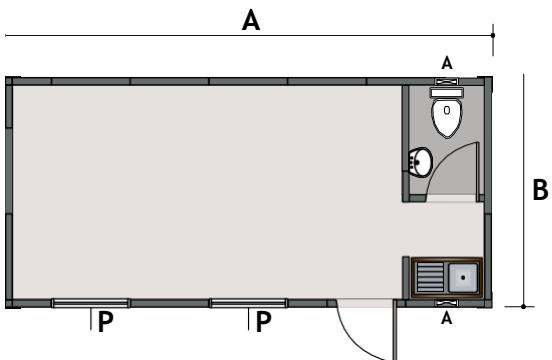

VK 204

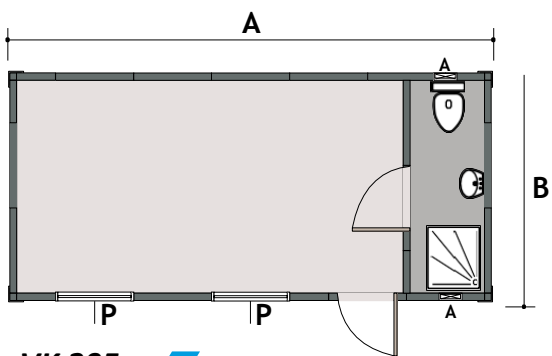

VK 205



A 7m 6m  
B 3m 2,4m

# CONTAINER PLÄNE

# CONTAINER PLANS

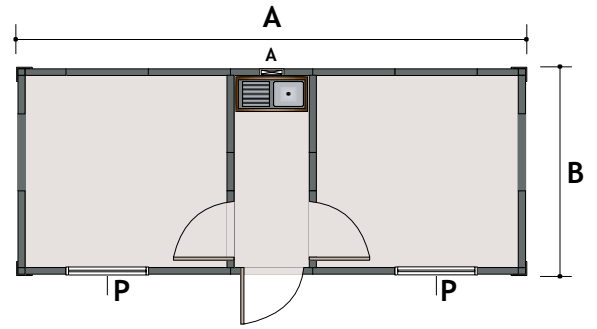

VK 301

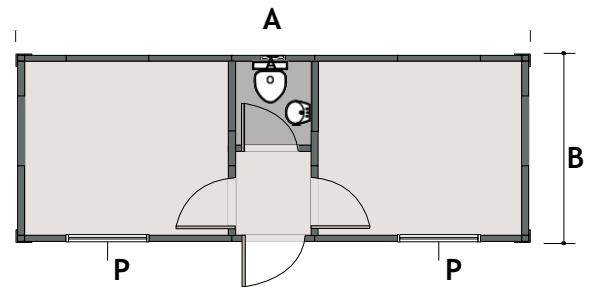

VK 302

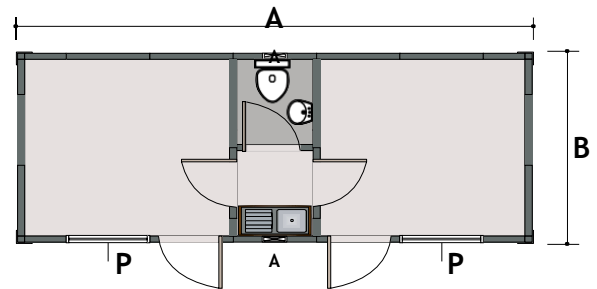

VK 303

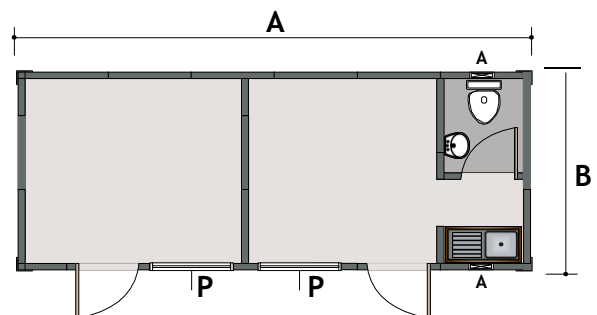

VK 304

A 7m 6m  
B 3m 2,4m



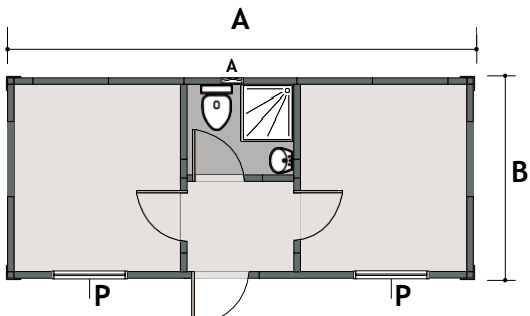

VK 305

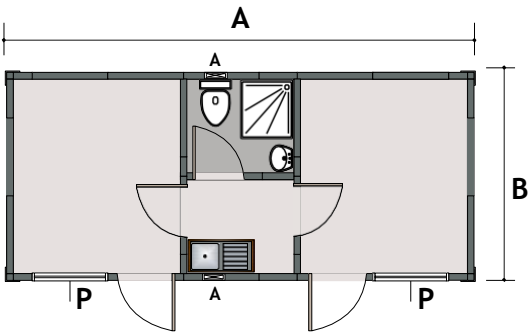

VK 306

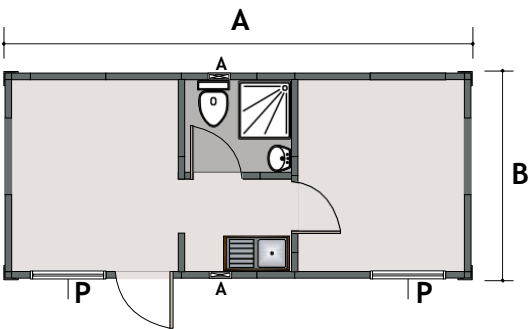

VK 701

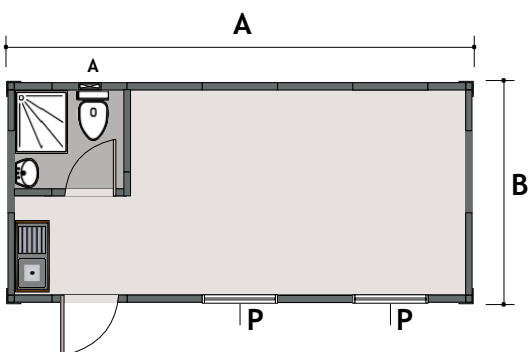

VK 801



A 7m 6m  
B 3m 2,4m



# WC DUSCH CONTAINER PLÄNE

# WC SHOWER CONTAINER PLANS

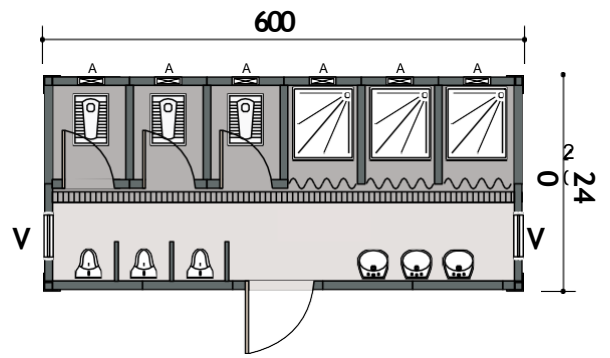

**VKW 06**

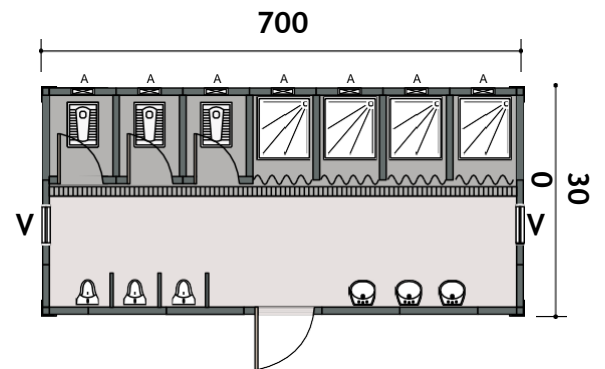

**VKW 07**

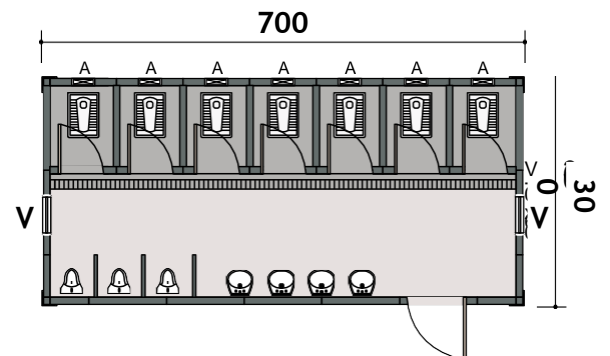

**VKW 10**



VKW 01

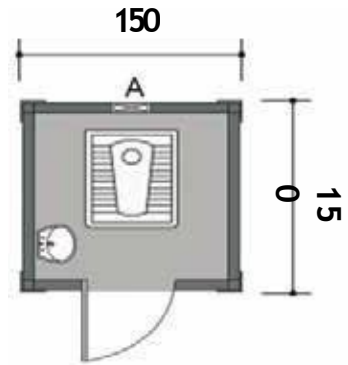

VKW 03

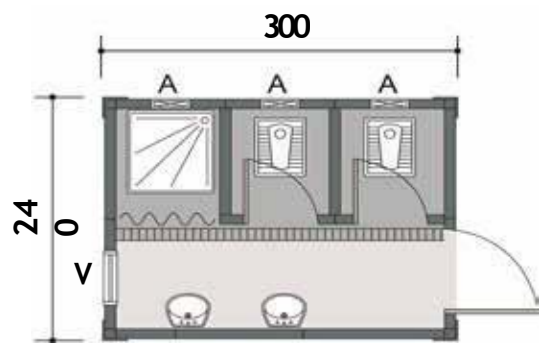

VKW 04

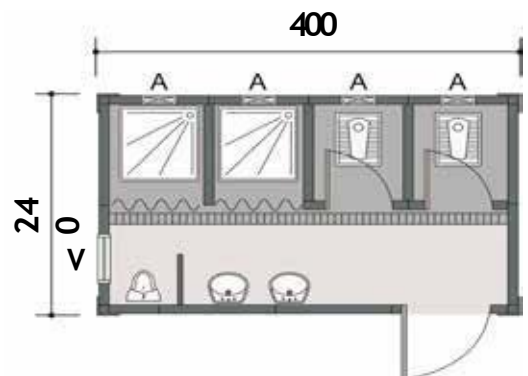

EKOW101

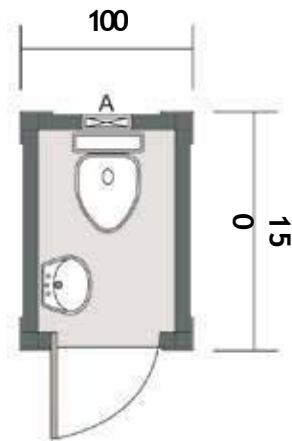

EKOW102

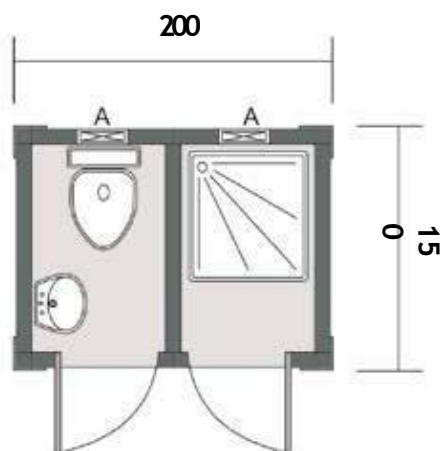

EKOW103

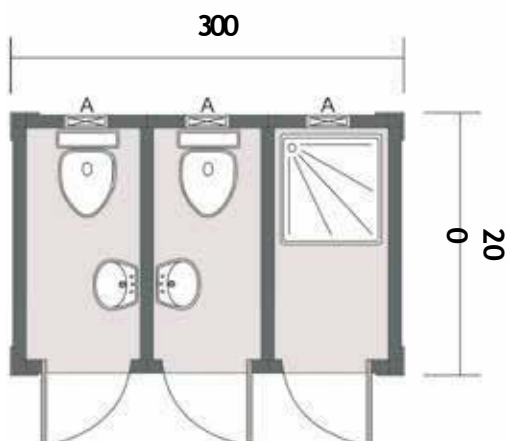

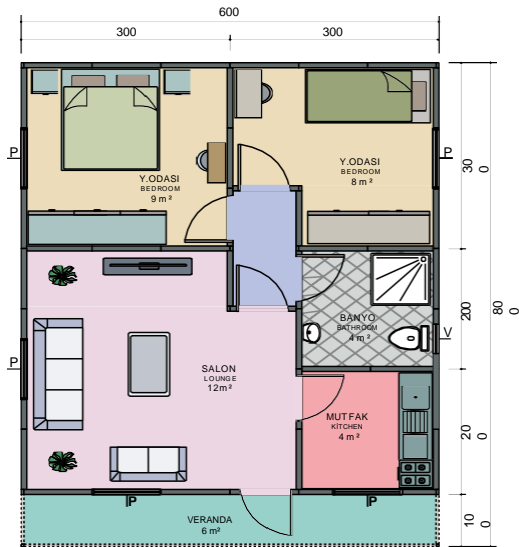

VKP1

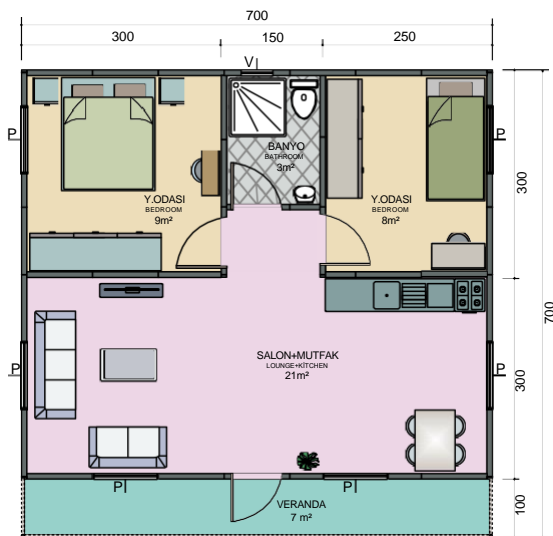

VKP2

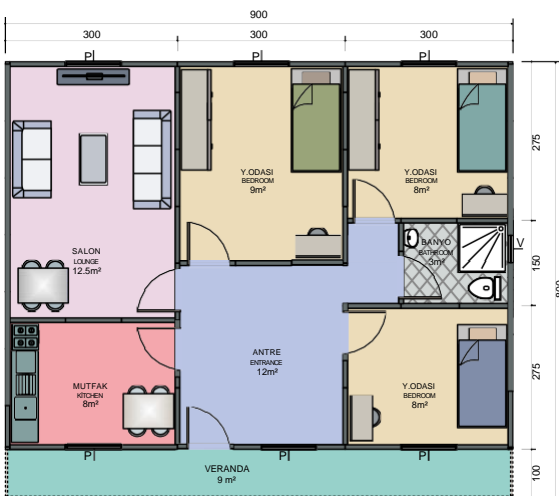

VKP3



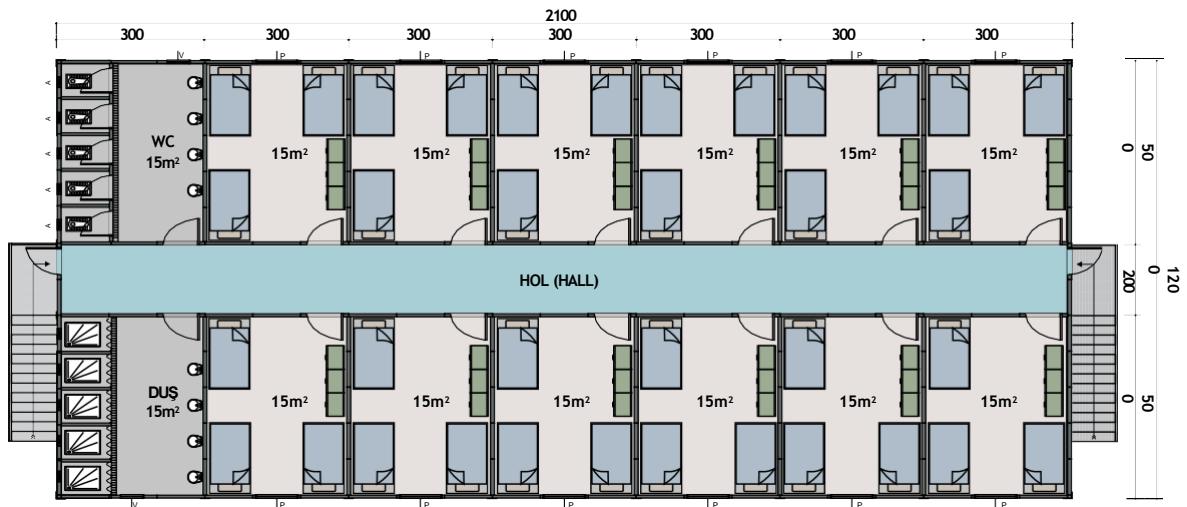

**O.G PLÄNE- First Floor (252m<sup>2</sup>)**

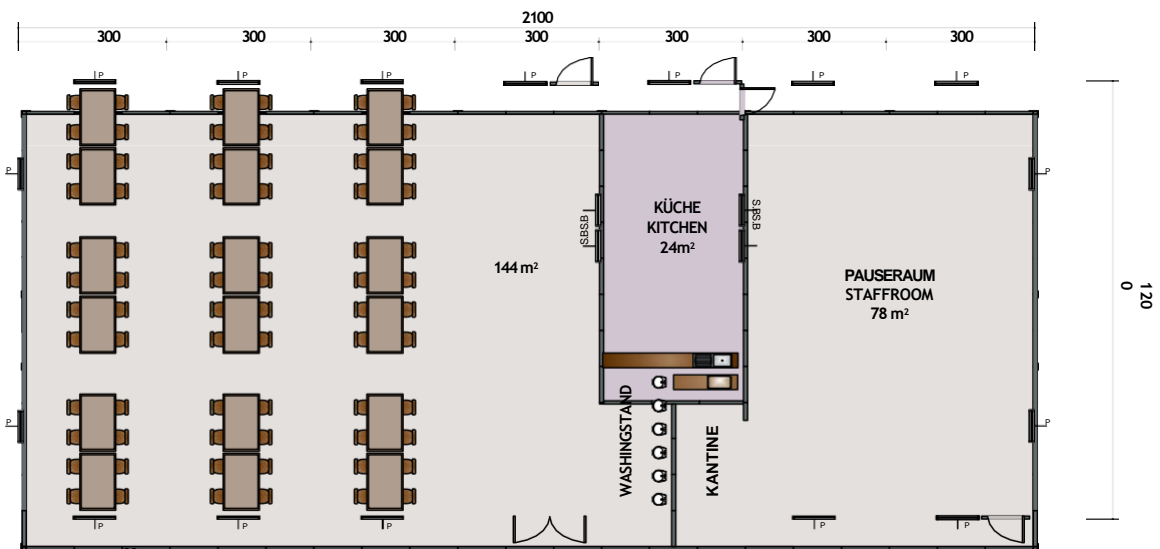

**E.G PLÄNE- Ground Floor (252m<sup>2</sup>)**

**504 m<sup>2</sup>**



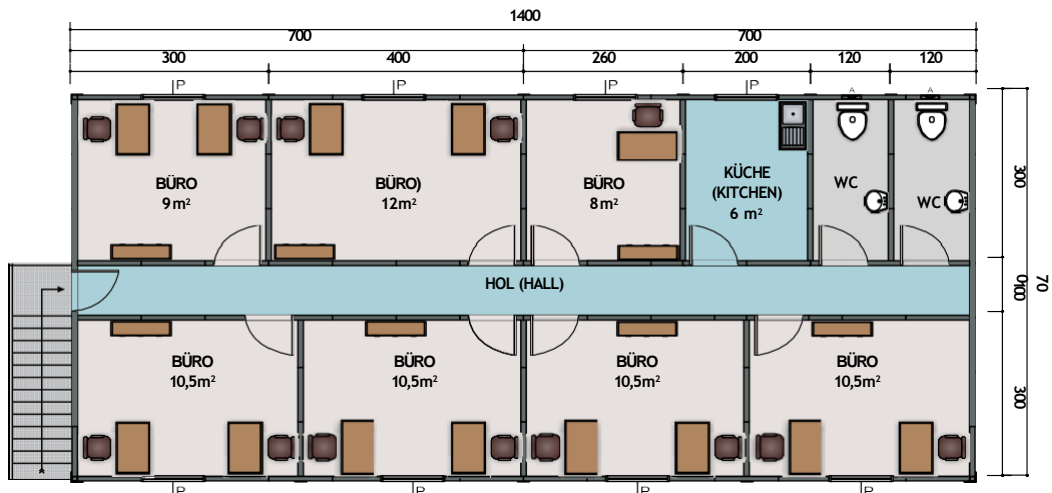

O.G PLÄNE- First Floor (98m<sup>2</sup>)

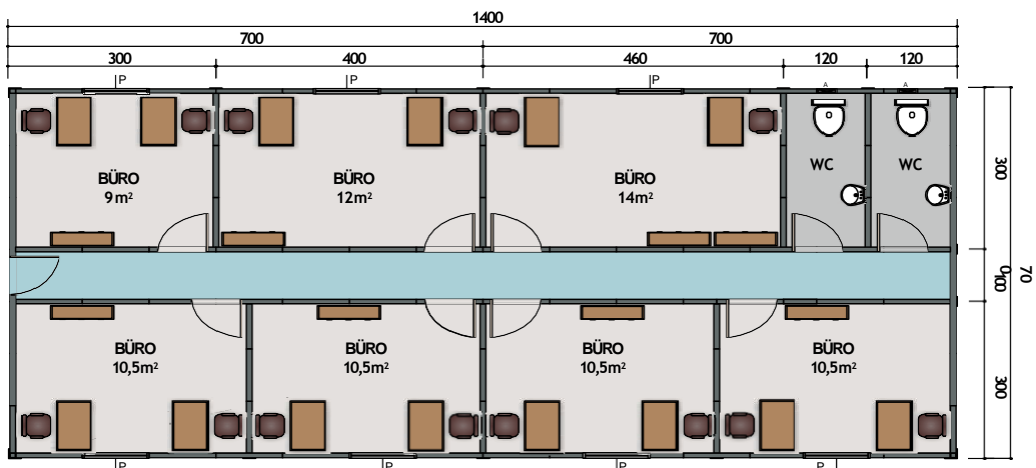

E.G PLÄNE - Ground Floor (98m<sup>2</sup>)

196 m<sup>2</sup>BÜRO

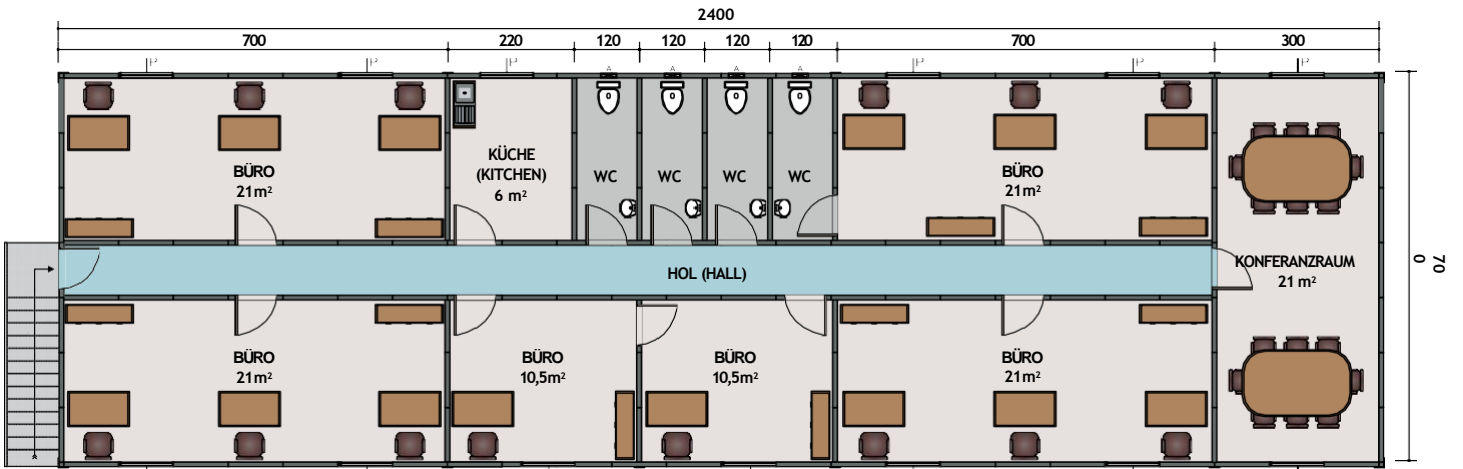

O.G PLÄNE - First Floor (168m<sup>2</sup>)

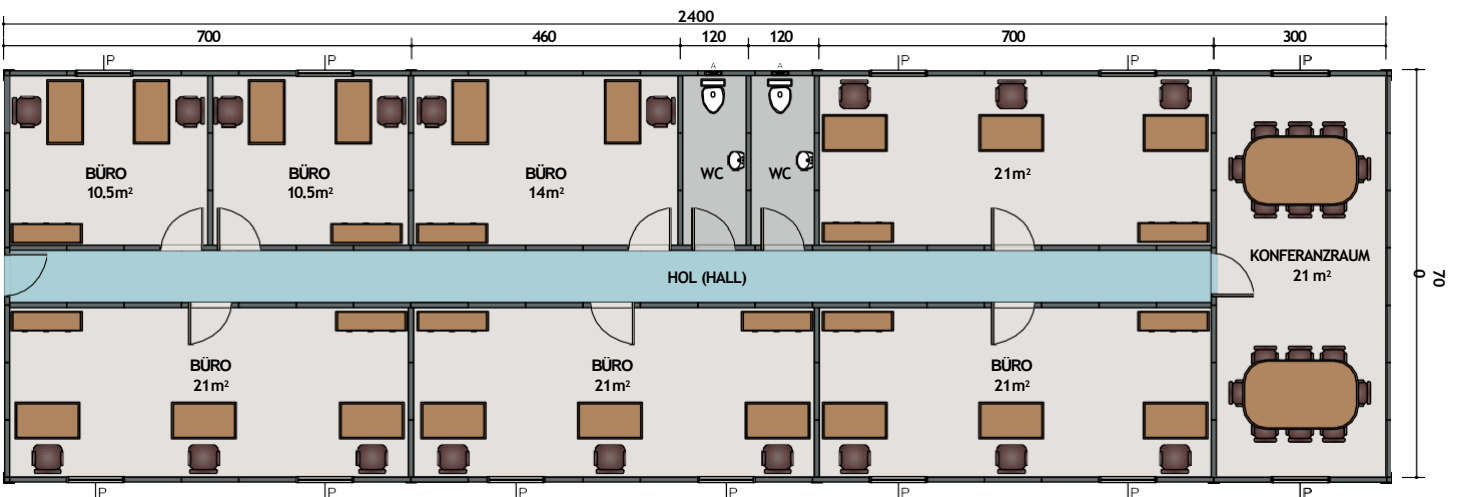

336 m<sup>2</sup>

E.G PLÄNE- Ground Floor (168m<sup>2</sup>)



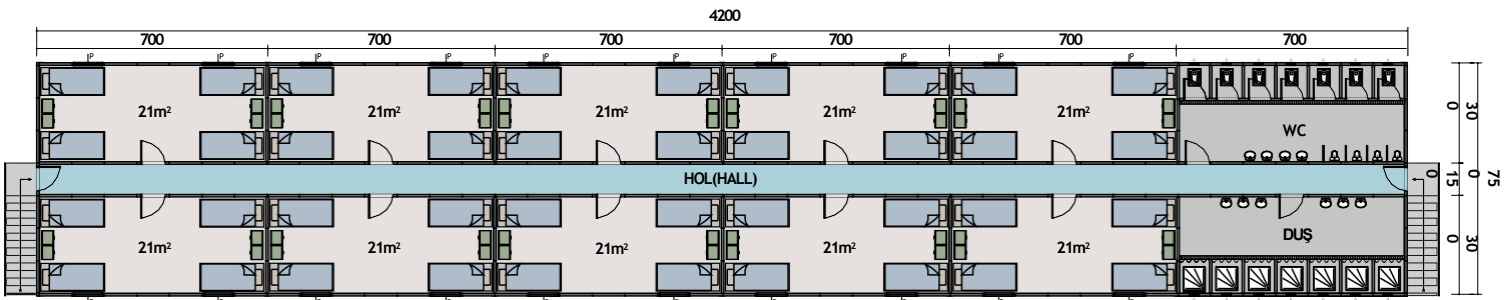

**O.G PLÄNE - First Floor (315m<sup>2</sup>)**

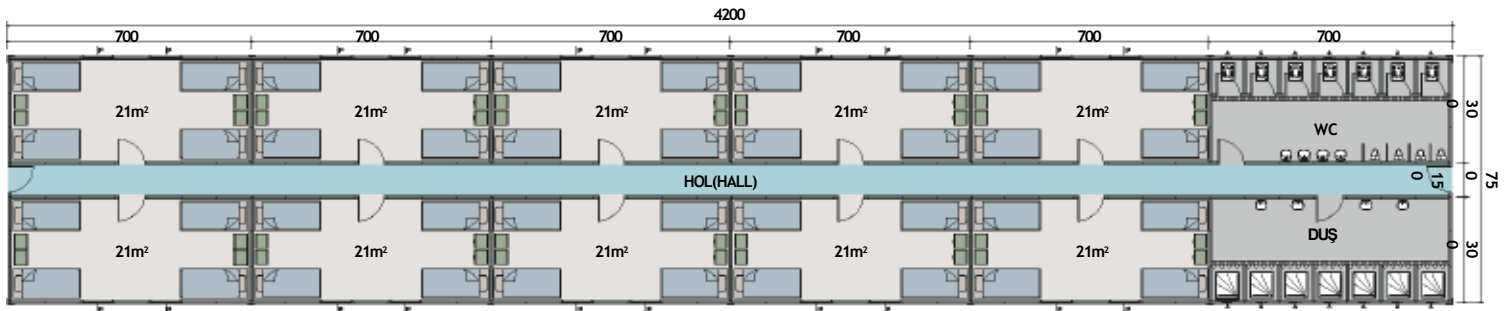

**E.G - Ground Floor (315m<sup>2</sup>)**

**630m<sup>2</sup>**



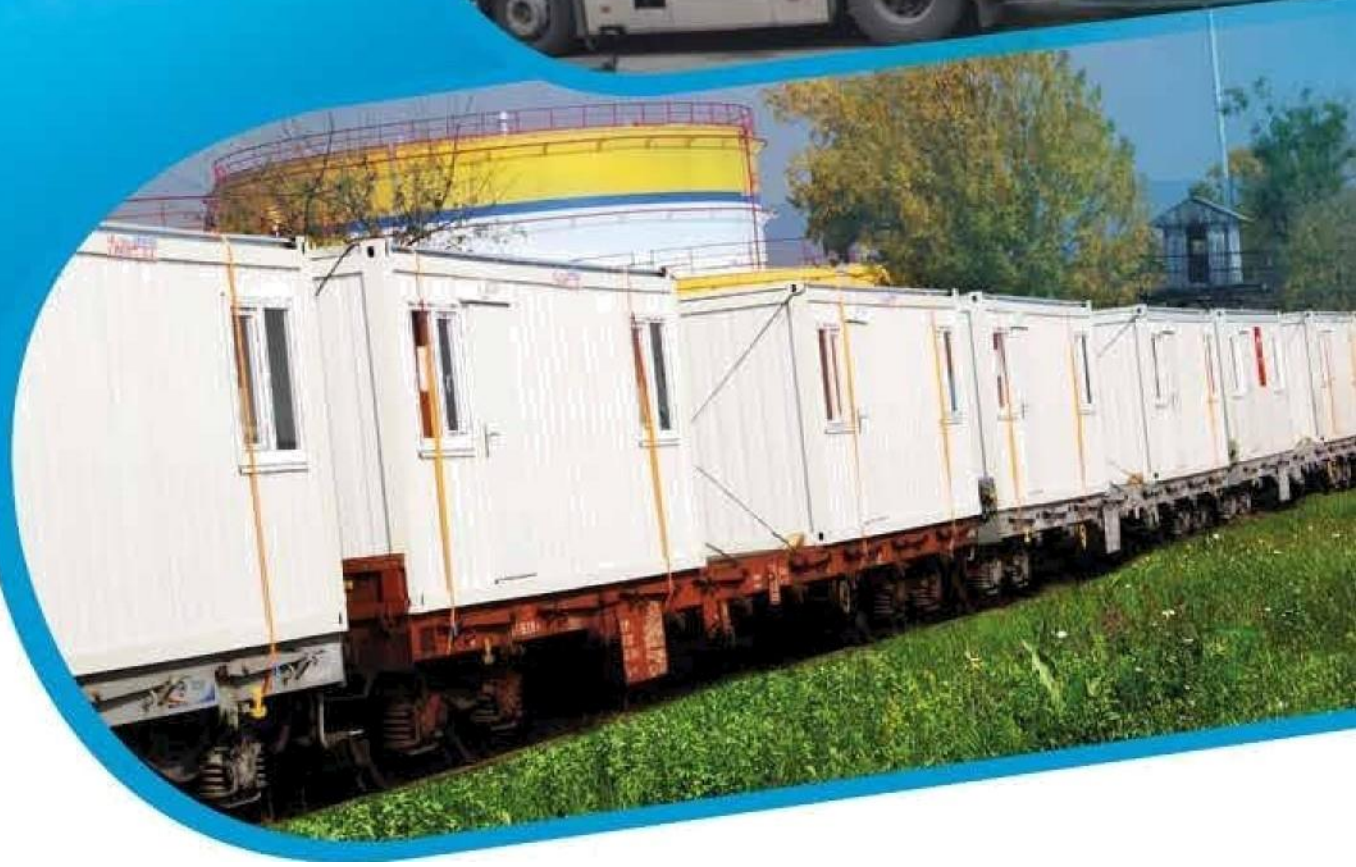

TRANSPORT







## TECHNICAL SPECIFICATIONS OF MODULAR CONTAINERS

DIMENSIONS	Tailor made production is available. Combination and multistorey containers can also be manufactured.		STANDARDS	Steel Betopan Glasswool Polystrene	St 37 TSE 634-2 TS 901 TS 7316
DATA	Earthquake	1. degree conditions	Outer wallheat conductivity	K: 0.40 Kcal/m <sup>2</sup> hC	
	Weather	3. climate region	Roof conductivity	K: 0.35 Kcal/m <sup>2</sup> hC	
	Snow load	80 kg/m <sup>2</sup>	Floor conductivity	K: 0.68 Kcal/m <sup>2</sup> hC	
	Wind load	102 km/hr	Floor load carrying capacity	200 kg/m <sup>2</sup>	
EXTERIOR WALL	Outer surface	0,50mm thickness COIL COATING painted, galvanized steel sheet			
	Insulation	40 mm thickness polystyrene			
	Inner surface	0,50mm thickness COIL COATING painted, galvanized steel sheet			
INTERIOR WALL	Surface	0,50mm thickness COIL COATING painted, galvanized steel sheet			
	Insulation	40 mm thickness polystyrene			
	Surface	0,50mm thickness COIL COATING painted, galvanized steel sheet			
POSTS-FLOOR	Galvanised construction	2 mm thickness specially formed omegas and profiles from steel are used.			
	Floor covering	16 mm thickness cemented board and over pvc mineflo are laid.			
CEILING-ROOF	Frame	2 mm thickness specially formed omegas and profiles from steel are used.			
	Roof covering	0.50mm thickness 27mm* 200mm natural galvanized steelsheet			
	Insulation	80mm thickness glasswoolblanket			
	Inner surface	High quality 10mm thickness,white PVC siding is used.			
DOORS	Exterior door	90*195in dimension- insulated steel door 0.50 mm thickness RaI9002 painted galvanized steelsheet			
	Interior door	80* 198 in dimension- two sides covered with MDF Frame is COILCOATING painted galvanized steelsheet.			
WINDOWS	Windows	95/100 in dimension PVC PAKPEN- Brand			
	Window frame	0,60 mm thickness naturel galvanized steelsheet			
	Skirting	PVC-White			
GLAZE	Double glass	4+12+4mm			
PAINT	Exterior surface	COIL COATING system RaI 9002			
	Door frames	One coat primary and RaI 9002 rapid paint is applied.			
	Poles	One coat primary and RaI 5017 rapid paint is applied.			
	Metal parts	One coat primary			
ELECTRICAL INSTALLATION over the surface	Cable	Electrical power2000W,220Volt sockets -3*2.5Nym, 2*1.5Nym for lighting ÖZNUR Brand.			
	Lighting	PELSAN and BALKAYAbands			
	Sockets and switches	VİKO brand-classic			
	Standard installment	1 pc socket, 1 pc telephone for each room,one glop aboveexterior door			
PLUMBING- over the surface	Vitrifies	DOĞVİTbrand			
	Taps	POLİSU brand			
	Clean water pipe	PPRC-Firat brand			
	Dirty water pipe	PVC-Firat-Gediz brand			
	Accessory	Toilet paper,soap holder,mirror,toilet seat			
LIFTING	Container should be lifted from top four corners by using steel ropes or slings				



VLK010

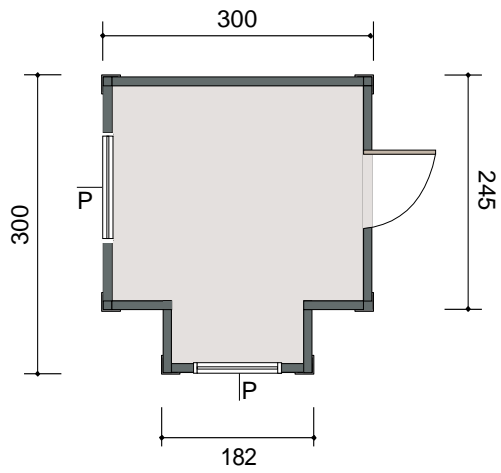

VLK011

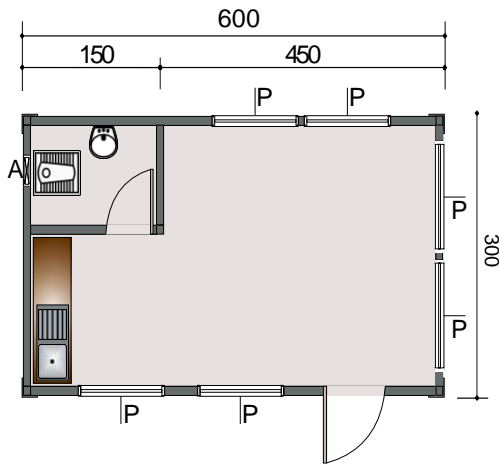

VLK012

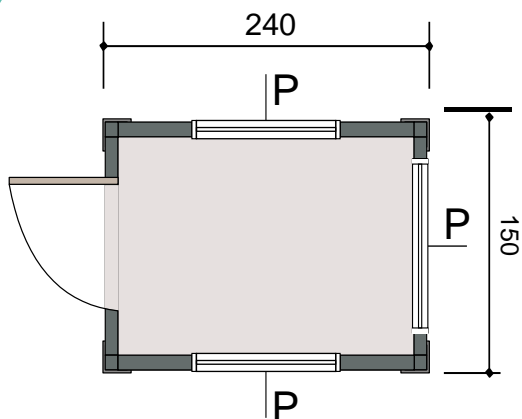

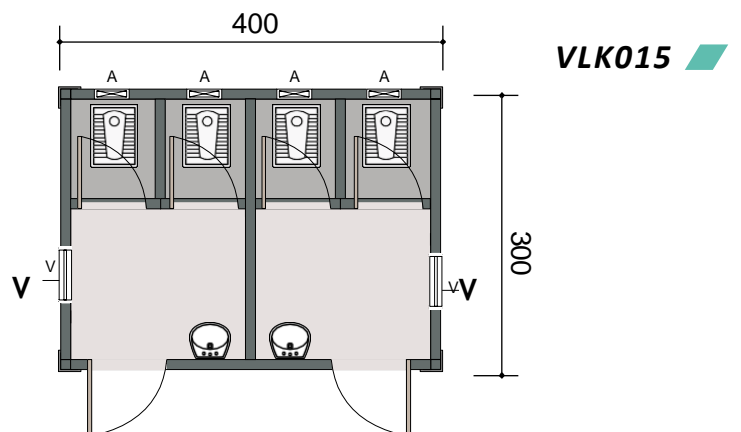
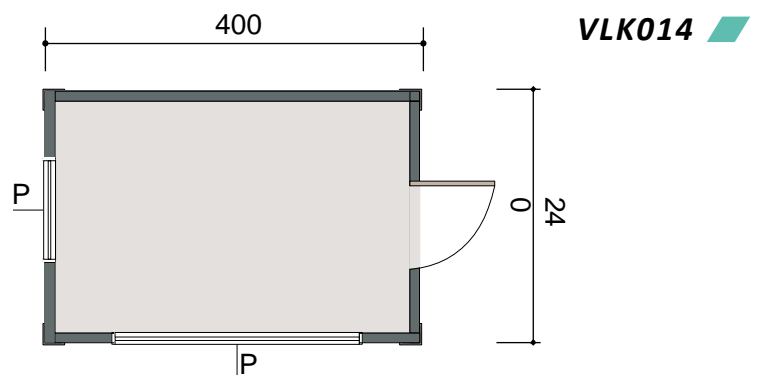
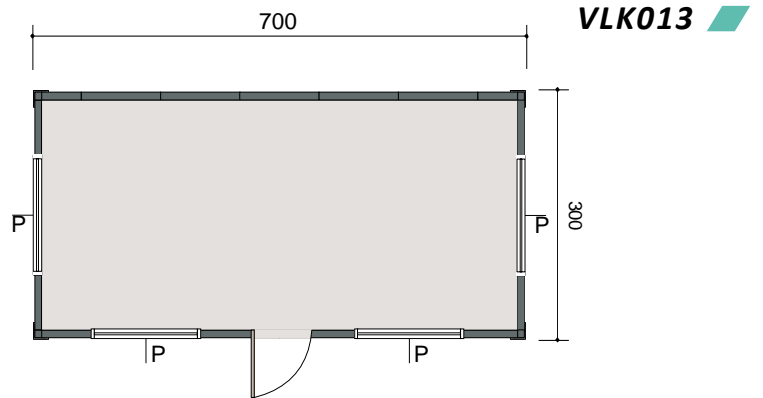



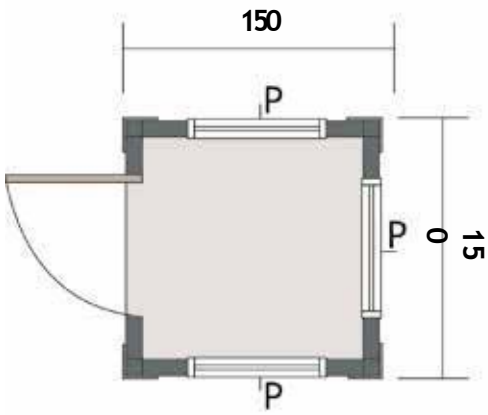

VLK101

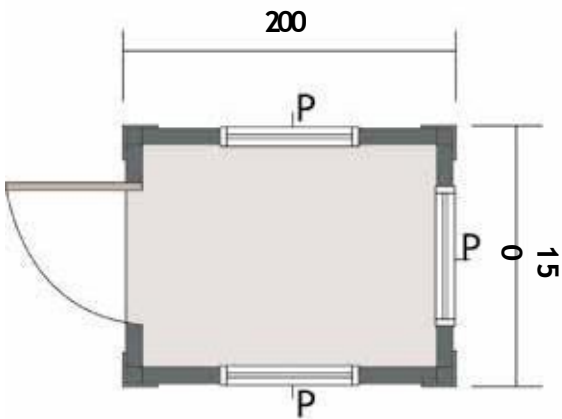

VLK102

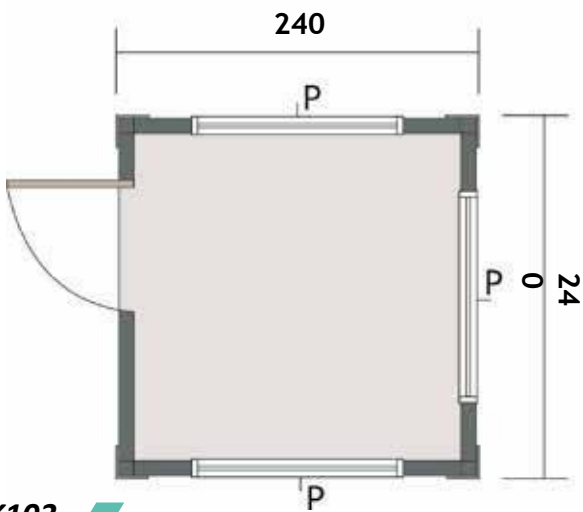

VLK103



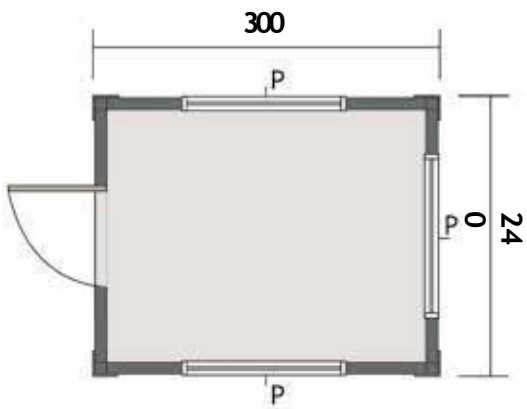

VLK104

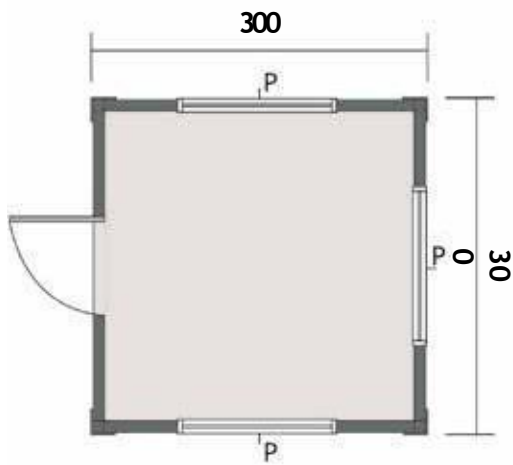

VLK105

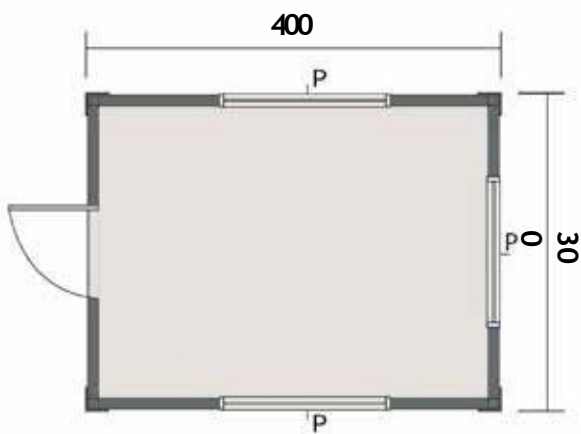

VLK106



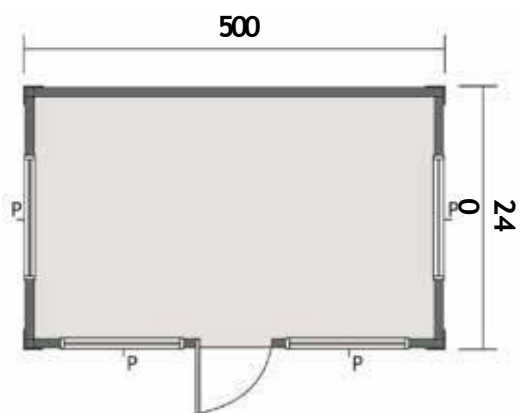

VLK107

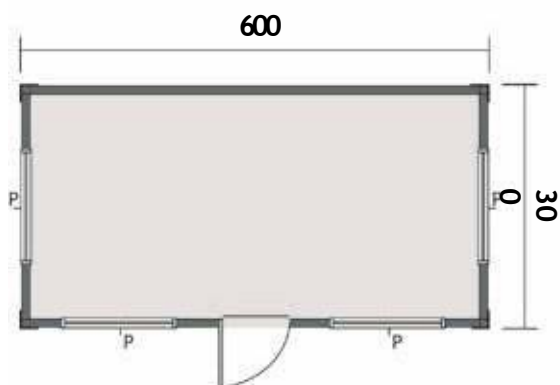

VLK108

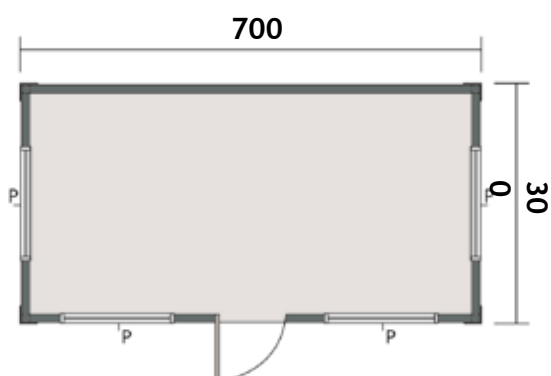

VLK109





SECURITY KABINEN  
SECURITY CABINS

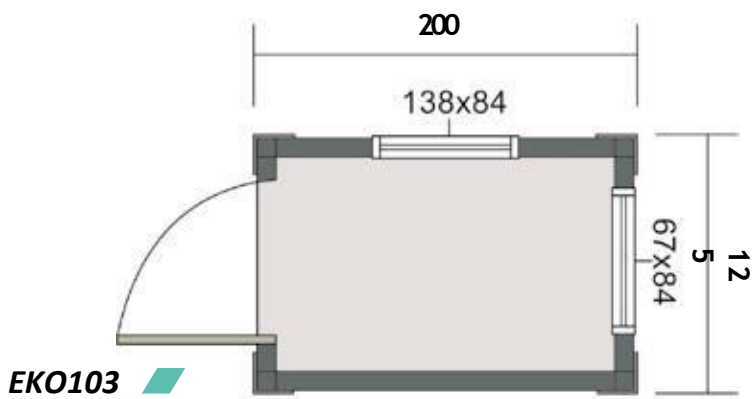
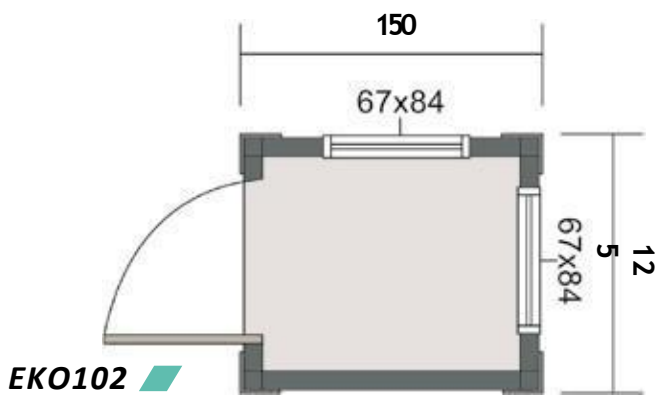
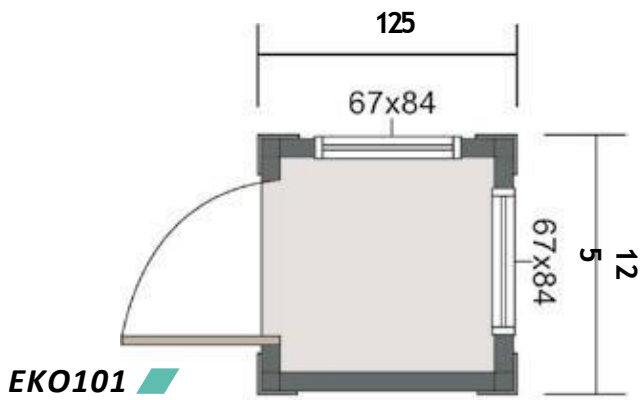

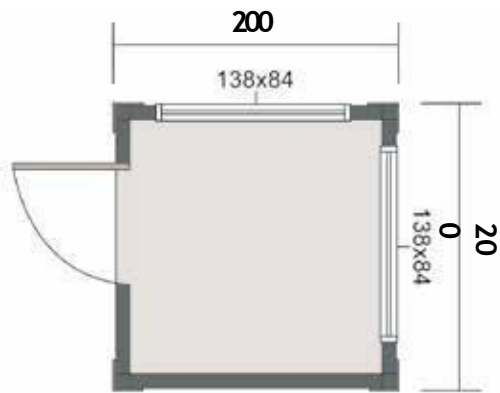

EKO104

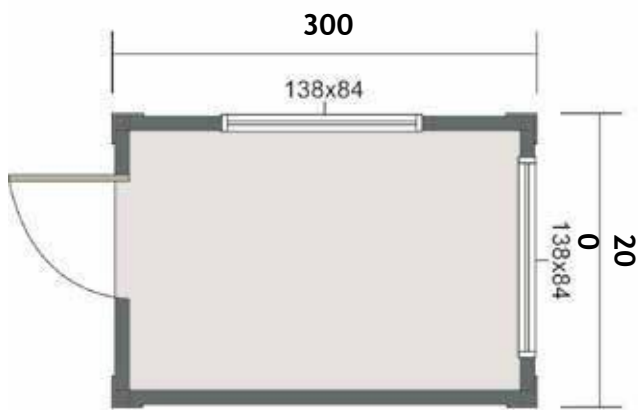

EKO105

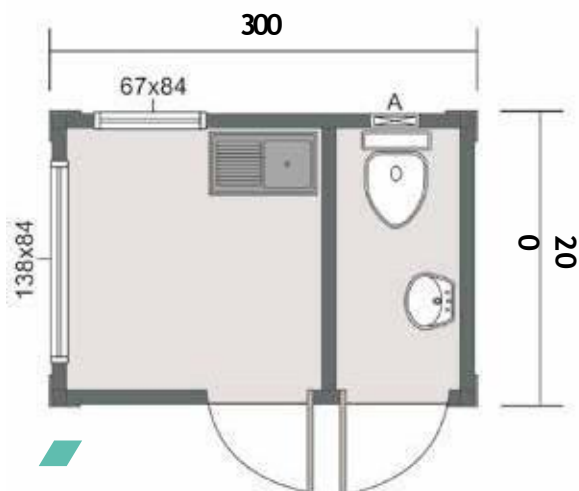

EKO106



# TECHNICAL SPECIFICATIONS OF SECURITY AND LUXURY CABINS

<b>DIMENSIONS</b>	Tailor made production is available. Combination and multistorey containers can also be manufactured.		<b>STANDARTLAR</b>	Steel	ST 37
				Betopan	TSE 634-2
<b>DATA</b>	Earthquake	1.degreeconditions	Outer wallheat conductivity	K: 0.40 Kcal/m <sup>2</sup> hC	
	Weather	3.climate region	Roof conductivity	K: 0.35 Kcal/m <sup>2</sup> hC	
	Snow load	80 kg/m <sup>2</sup>	Floor conductivity	K: 0.68 Kcal/m <sup>2</sup> hC	
	Wind load	102 km/hr	Floor load carrying capacity	200 kg/m <sup>2</sup>	
<b>SECURITY CABIN- EXTERIORWALL</b>	Inner surface	0,50mm thickness COIL COATING painted, galvanized steel sheet			
	Insulation	40 mm thickness polystyrene			
	Inner surface	0,50mm thickness COIL COATING painted, galvanized steel sheet			
<b>LUXURY CABIN EXTERIOR WALL</b>	Outer surface	12 mm thickness wood texture cementboard			
	Insulation	40 mm thickness polystyrene			
	Inner surface	8 mm thickness wood texture cementboard			
<b>INTERIOR WALL</b>	Surface	Lux cabin:8mm cement board/ Security cabin:0,50mmpainted steel sheet			
	Insulation	40 mm thickness polystyrene			
	Surface	Lux cabin:8mm cement board/ Security cabin:0,50mmpainted steel sheet			
<b>POSTS-FLOOR</b>	Galvanised construction	2 mm thickness specially formed omegas and profiles from steel are used.			
	Floor covering	16 mm thickness cemented board and over pvc mineflo are laid.			
<b>CEILING-ROOF</b>	Frame	2 mm thickness specially formed omegas and profiles from steel are used.			
	Roof covering	0.50mm thickness 27mm* 200mm natural galvanized steelsheet			
	Insulation	80mm thickness glasswoolblanket			
	Inner surface	High quality 10mm thickness,white PVC siding is used.			
<b>DOORS</b>	Exterior door	90 *195in dimension- insulated steel door 0.50 mm thickness Ral9002 painted galvanized steelsheet			
	Interior door	80 * 198 in dimension- two sides covered with MDF Frame is COILCOATING painted galvanized steelsheet			
<b>WINDOWS</b>	Windows	95/100 in dimension PVC PAKPEN- Brand			
	Window frame	0,60 mm thickness naturel galvanized steelsheet			
	Skirting	PVC-White			
<b>GLASS</b>	Double glass	4+12+4mm			
<b>PAINT</b>	Exterior surface	COIL COATING system Ral 9002			
	Door frames	One coat primary and Ral 9002 rapid paint is applied.			
	Poles	One coat primary and Ral 5017 rapid paint is applied.			
	Metal parts	One coat primary			
<b>ELECTRICAL INSTALLATION over the surface</b>	Cable	Electrical power 2000W, 220 Volt sockets -3*2.5Nym, 2*1.5Nym for lighting ÖZNUR Brand.			
	Lighting	PELSAN and BALKAYA brands			
	Sockets and switches	VİKO brand-classic			
	Standard installment	1 pc socket, 1 pc telephone for each room, one glop above exterior door			
<b>PLUMBING over the surface</b>	Vitrifies	DOĞVİTbrand			
	Taps	POLİSU brand			
	Clean water pipe	PPRC-Firat brand			
	Dirty water pipe	PVC-Firat-Gediz brand			
	Accessory	Toilet paper, soap holder, mirror, toilet seat			
<b>LIFTING</b>	Container should be lifted from top four corners by using steel ropes or slings				



# KALİTE SERTİFİKALARIMIZ

TIC 15 100 148797 No. lu  
Sertifika ya ek



**VİLLA YAPI MÜHENDİSLİK SAN. VE TİC. LTD. ŞTİ.**  
İçmeler Mahallesi Mazhar Sok. No: 15  
Tuzla - İstanbul / Türkiye

Aşağıda belirtilen Şubeler Sertifika kapsamına dahildir

**Merkez**

**VİLLA YAPI MÜHENDİSLİK SAN. VE TİC. LTD. ŞTİ.**  
İçmeler Mahallesi Mazhar Sok. No: 15  
Tuzla - İstanbul / Türkiye  
Kapsam: Prefabrik yapı tasarımı, imalati ve satışı  
Sertifika No: TIC 15 100 148797

**Şubeler**

**VİLLA YAPI MÜHENDİSLİK SAN. VE TİC. LTD. ŞTİ.**  
Cumhuriyet Mah. Gönney Yanyol Cad. No: 24  
Gebze - Kocaeli / Türkiye  
Kapsam: Prefabrik yapı tasarımı, imalati ve satışı  
Sertifika No: TIC 15 100 148797/1



June 2014-02-10



Enclosure to  
Certificate-No TIC 15 100 148797



**VİLLA YAPI MÜHENDİSLİK SAN. VE TİC. LTD. ŞTİ.**  
İçmeler Mahallesi Mazhar Sok. No: 15  
Tuzla - İstanbul / Türkiye

Following local branches are part of the certificate

**Central office**

**VİLLA YAPI MÜHENDİSLİK SAN. VE TİC. LTD. ŞTİ.**  
İçmeler Mahallesi Mazhar Sok. No: 15  
Tuzla - İstanbul / Türkiye  
Scope: Design, production and sales of prefabricated construction  
Certificate-№ TIC 15 100 148797

**Locations**

**VİLLA YAPI MÜHENDİSLİK SAN. VE TİC. LTD. ŞTİ.**  
Cumhuriyet Mah. Gönney Yanyol Cad. No: 24  
Gebze - Kocaeli / Türkiye  
Scope: Design, production and sales of prefabricated construction  
Certificate-№ TIC 15 100 148797/1



June 2014-02-10



Anlage zum  
Zertifikat-Nr. TIC 15 100 148797



**VİLLA YAPI MÜHENDİSLİK SAN. VE TİC. LTD. ŞTİ.**  
İçmeler Mahallesi Mazhar Sok. No: 15  
Tuzla - İstanbul / Türkiye

Folgender Standort ist Bestandteil des Zertifikates:

**Zentrale**

**VİLLA YAPI MÜHENDİSLİK SAN. VE TİC. LTD. ŞTİ.**  
İçmeler Mahallesi Mazhar Sok. No: 15  
Tuzla - İstanbul / Türkei  
Umfangsbereich:  
Entwicklung, Herstellung und Verkauf von vorgefertigten Baukonstruktionen  
Zertifikat-Nr.: TIC 15 100 148797

**Standort**

**VİLLA YAPI MÜHENDİSLİK SAN. VE TİC. LTD. ŞTİ.**  
Cumhuriyet Mah. Gönney Yanyol Cad. No: 24  
Gebze - Kocaeli / Türkei  
Umfangsbereich:  
Entwicklung, Herstellung und Verkauf von vorgefertigten Baukonstruktionen  
Zertifikat-Nr.: TIC 15 100 148797/1



June 2014-02-10



## SERTİFİKA



ISO 9001:2008'e göre  
yönetim sistemi

Belgelendirme prosedürleri doğrultusunda ve düzenlemeler ile uyumlu uygulamaların kanıtlanması ile



**VİLLA YAPI MÜHENDİSLİK SAN. VE TİC. LTD. ŞTİ.**  
Fabrik: Cumhuriyet Mah. Gönney Yanyol Cad. No: 24  
Gebze - Kocaeli / Türkiye

Önemli kuruluşun, belirlen standartlar göre, uygulamış güçlüğü alanında bir yönetim sistemi uyguladığı belgelendirilmiştir.  
Geçerlilik alanı

Prefabrik yapı tasarımı, İmalatı ve satışı

Sertifika Tevdihi No: TIC 15 100 148797/1     2017-02-08     İmalatın başlatıldığı  
2014-02-10     İmalatın bitmesi

Teşvik Raporu No: 3330 2N65 A0

Bu sertifikasyonu TIC, ilgili ve belgelendirme prosedürleri göre gerçekleştirilmiştir ve ilave denetimler yaptırılarak güncellenmiştir.



June 2014-02-10



## CERTIFICATE



for the management system  
according to ISO 9001:2008

The proof of the conforming application with the regulation is  
furnished and in accordance with certification procedure it is certified  
for the company



**VİLLA YAPI MÜHENDİSLİK SAN. VE TİC. LTD. ŞTİ.**  
Factory: Cumhuriyet Mah. Gönney Yanyol Cad. No: 24  
Gebze - Kocaeli / Turkey

Scope:

Design, production and sales  
of prefabricated construction

Certificate Registration No.: TIC 15 100 148797/1     Valid until: 2017-02-08  
Valid from: 2014-02-10

Audit Report No.: 3330 2N65 A0

This certification was conducted in accordance with the TIC auditing and certification procedures and is subject to regular surveillance audits.



June 2014-02-10



## ZERTIFIKAT



für das Managementsystem  
nach DIN EN ISO 9001:2008

Die regelwerkconforme Anwendung wurde nachgewiesen  
und wird gemäß Zertifizierungsverfahren bescheinigt für das  
Unternehmen



**VİLLA YAPI MÜHENDİSLİK SAN. VE TİC. LTD. ŞTİ.**  
İçmeler Mahallesi Mazhar Sok. No:15  
Tuzla - İstanbul / Türkei  
mit der Niederlassung (siehe Anlage)

Geltungsbereich:

Entwicklung, Herstellung und Verkauf  
von vorgefertigten Baukonstruktionen

Zertifikat-Registrierung-Nr.: TIC 15 100 148797     Gültig bis: 2017-02-08  
Gültig ab: 2014-02-10

Audit Bericht-Nr.: 3330 2N65 A0

Diese Zertifizierung wurde gemäß TIC-Verfahren zur Ausführung und Zertifizierung durchgeführt und wird regelmäßig überwacht.



June 2014-02-10



### TSE TÜRK STANDARLARI ENSTİTÜSÜ TÜRK STANDARLARINA UYGUNLUK BELGESİ TURKISH STANDARDS INSTITUTION CERTIFICATE OF CONFORMITY TO TURKISH STANDARDS

Ürünün Tanımı - Description of the Product	
TSE	
Ürün Adı / Name of the Product	15 100 148797/1
Ürünün Tanımı / Description of the Product	15 100 148797/1
Ürünün Tanımı / Description of the Product	15 100 148797/1
Ürünün Tanımı / Description of the Product	15 100 148797/1
Ürünün Tanımı / Description of the Product	15 100 148797/1
Ürünün Tanımı / Description of the Product	15 100 148797/1
Ürünün Tanımı / Description of the Product	15 100 148797/1
Ürünün Tanımı / Description of the Product	15 100 148797/1
Ürünün Tanımı / Description of the Product	15 100 148797/1
Ürünün Tanımı / Description of the Product	15 100 148797/1
Ürünün Tanımı / Description of the Product	15 100 148797/1
Ürünün Tanımı / Description of the Product	15 100 148797/1
Ürünün Tanımı / Description of the Product	15 100 148797/1
Ürünün Tanımı / Description of the Product	15 100 148797/1
Ürünün Tanımı / Description of the Product	15 100 148797/1
Ürünün Tanımı / Description of the Product	15 100 148797/1
Ürünün Tanımı / Description of the Product	15 100 148797/1
Ürünün Tanımı / Description of the Product	15 100 148797/1
Ürünün Tanımı / Description of the Product	15 100 148797/1
Ürünün Tanımı / Description of the Product	15 100 148797/1
Ürünün Tanımı / Description of the Product	15 100 148797/1
Ürünün Tanımı / Description of the Product	15 100 148797/1
Ürünün Tanımı / Description of the Product	15 100 148797/1
Ürünün Tanımı / Description of the Product	15 100 148797/1

Ürünün Tanımı / Description of the Product: 15 100 148797/1

### TSE TÜRK STANDARLARI ENSTİTÜSÜ TÜRK STANDARLARINA UYGUNLUK BELGESİ TURKISH STANDARDS INSTITUTION CERTIFICATE OF CONFORMITY TO TURKISH STANDARDS

Ürünün Tanımı - Description of the Product	
TSE	
Ürün Adı / Name of the Product	15 100 148797/1
Ürünün Tanımı / Description of the Product	15 100 148797/1
Ürünün Tanımı / Description of the Product	15 100 148797/1
Ürünün Tanımı / Description of the Product	15 100 148797/1
Ürünün Tanımı / Description of the Product	15 100 148797/1
Ürünün Tanımı / Description of the Product	15 100 148797/1
Ürünün Tanımı / Description of the Product	15 100 148797/1
Ürünün Tanımı / Description of the Product	15 100 148797/1
Ürünün Tanımı / Description of the Product	15 100 148797/1
Ürünün Tanımı / Description of the Product	15 100 148797/1
Ürünün Tanımı / Description of the Product	15 100 148797/1
Ürünün Tanımı / Description of the Product	15 100 148797/1
Ürünün Tanımı / Description of the Product	15 100 148797/1
Ürünün Tanımı / Description of the Product	15 100 148797/1
Ürünün Tanımı / Description of the Product	15 100 148797/1
Ürünün Tanımı / Description of the Product	15 100 148797/1
Ürünün Tanımı / Description of the Product	15 100 148797/1
Ürünün Tanımı / Description of the Product	15 100 148797/1
Ürünün Tanımı / Description of the Product	15 100 148797/1
Ürünün Tanımı / Description of the Product	15 100 148797/1
Ürünün Tanımı / Description of the Product	15 100 148797/1
Ürünün Tanımı / Description of the Product	15 100 148797/1
Ürünün Tanımı / Description of the Product	15 100 148797/1

Ürünün Tanımı / Description of the Product: 15 100 148797/1

### TSE TÜRK STANDARLARI ENSTİTÜSÜ TÜRK STANDARLARINA UYGUNLUK BELGESİ TURKISH STANDARDS INSTITUTION CERTIFICATE OF CONFORMITY TO TURKISH STANDARDS

Ürünün Tanımı - Description of the Product	
TSE	
Ürün Adı / Name of the Product	15 100 148797/1
Ürünün Tanımı / Description of the Product	15 100 148797/1
Ürünün Tanımı / Description of the Product	15 100 148797/1
Ürünün Tanımı / Description of the Product	15 100 148797/1
Ürünün Tanımı / Description of the Product	15 100 148797/1
Ürünün Tanımı / Description of the Product	15 100 148797/1
Ürünün Tanımı / Description of the Product	15 100 148797/1
Ürünün Tanımı / Description of the Product	15 100 148797/1
Ürünün Tanımı / Description of the Product	15 100 148797/1
Ürünün Tanımı / Description of the Product	15 100 148797/1
Ürünün Tanımı / Description of the Product	15 100 148797/1
Ürünün Tanımı / Description of the Product	15 100 148797/1
Ürünün Tanımı / Description of the Product	15 100 148797/1
Ürünün Tanımı / Description of the Product	15 100 148797/1
Ürünün Tanımı / Description of the Product	15 100 148797/1
Ürünün Tanımı / Description of the Product	15 100 148797/1
Ürünün Tanımı / Description of the Product	15 100 148797/1
Ürünün Tanımı / Description of the Product	15 100 148797/1
Ürünün Tanımı / Description of the Product	15 100 148797/1
Ürünün Tanımı / Description of the Product	15 100 148797/1
Ürünün Tanımı / Description of the Product	15 100 148797/1
Ürünün Tanımı / Description of the Product	15 100 148797/1
Ürünün Tanımı / Description of the Product	15 100 148797/1

Ürünün Tanımı / Description of the Product: 15 100 148797/1





F



**RC MONTAGE  
SERVICE**  
*Leistung schafft Vertrauen*



**Merkez Ofis /Head Office**  
Gladbacher straÙe 236  
50189 Elsdorf  
Tel : 017645836091

**Fabrik /Factory**  
Cumhuriyet Mh. Güney Yanyol Cd.  
No:24 Gebze /Kocaeli /Türkiye  
Tel : +9 0 262 653 06 55 (pbx)  
Faks : +9 0 262 653 06 76